

PRODUCT INFORMATION & SPECIFICATIONS

SERVICE SHOT SYSTEM

The Service Shot System was designed to safely and efficiently expedite short, shallow bores. These are often residential service line shots from the street to a house, or across a driveway. These scenarios often involve many shots within a single day that require fast, easy steering underground and minimal cleanup between shots to keep production rates high. The Service Shot System provides a small diameter housing and bit designed for minimal fluid use that makes each shot quick and not-so-dirty.

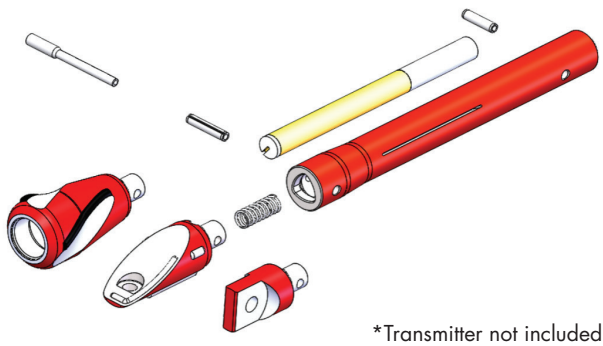

KEY FEATURES

- End-load housing for 15" DigiTrak and U-Mag Transmitters
- Compatible Rigs: JT10, JT921, JT922, D8x12, D10x15, D7x11, D6x6 (rigs with 10,000lbs thrust or less)
- 1.66 FS1 Rear thread (31F)
- The *non-threaded* connection provides easy alignment, clocking, and takes the torque load off the coiled pins
- Since fluid is minimal at best, it helps clean-up & production rate
- Best suited for shorter, shallow shots up to 18" deep
- The small diameter provides faster, easier steering in crowded or tight underground situations
- Bit comes with integrated pulling eye for direct pullback options
- Coiled pin connections for fast, easy removal and insertion
- Compatible adapters: 31M-09M-12, 31M-01M-12, 31M-31F-12

PARTS & COMPONENTS

Description	Part #	Quantity	Details
End-load Service Shot Housing	2622-HT	1	Sold Individually
2.75" End-load Bit	2622-BB27	1	Sold Individually
4" Juggernaut-style Reamer	2622-RJD-44F	1	Sold Individually
Rear Coiled Pin (0.5 x 2.0")	CP-050-200-SD	1	Included W/Housing
Front Heavy-duty Coiled Pin (0.5 x 2.5")	CP-050-250-HD	4	Included W/Housing
Transmitter Compression Spring	2622-HT-SPRING	1	Included W/Housing
7/16" Coiled Pin Punch Tool	PUNCH-RP-044	1	Included W/Housing
Pulling Eye	2622-EYE305	1	Sold Individually

*1/2" Shackle is recommended, but not included